



DB SERIES TUBULAR DEADBOLTS



OAK™ Security Group represents strength and stability in providing extensive experience, expertise and appropriate solutions that provide enhanced protection for your facilities. With all of these solutions comes our unparalleled, direct support.

Our unique philosophy is selling direct to you.

The OAK™ team brings a wealth of experience in listening, building relationships and applying appropriate solutions as well as extensive product development and manufacturing experience. These long-term relationships help us understand your needs, and our extensive experience equip us to recommend the most effective products and services. We work directly with our customer to design, implement and support a comprehensive facility solution. Our customized design is based on a foundation of high quality OAK™ locks, industry leading solutions and custom keying systems.

We can customize new systems or seamlessly integrate our solutions into your existing systems, so you need not disrupt what you've carefully built. The results are a "best in class" solution, with a wider range of proven products, all backed by superior service and support.



TABLE OF CONTENTS

OAK 11DB/2DB Series	4
Exploded Parts	4
11DB Features	5
2DB Features	5
Functions	5
Specifications	6
Door Preparation	6
How to Order	6
Systems Approach	7
Finishes	7

OAK™ DB Series Tubular Deadbolt

The OAK™ Security Group DB series deadbolts are designed to provide unparalleled strength and security to meet the needs of a wide range of commercial applications. The OAK™ 11DB tubular deadbolt is crafted with solid brass, free-turning cylinder rings, solid cast trim rings inside and out, and with an integrated manipulation-preventing shield molded into the outside trim ring to thwart attempted attacks. The 11DB deadbolt has been designed to surpass Grade 1 requirements of ANSI A156.36, and the 2DB deadbolt is designed to surpass the Grade 2 requirements of ANSI A156.36. Whatever commercial deadbolt challenges you face, OAK™ Security Group can help you develop DB series tubular deadbolt specifications to meet your needs, as well as assisting you with many other products and master keying needs. When you need experienced support, rely on the OAK™ experience.



11DB

11DB Tubular Deadbolt Exploded Parts

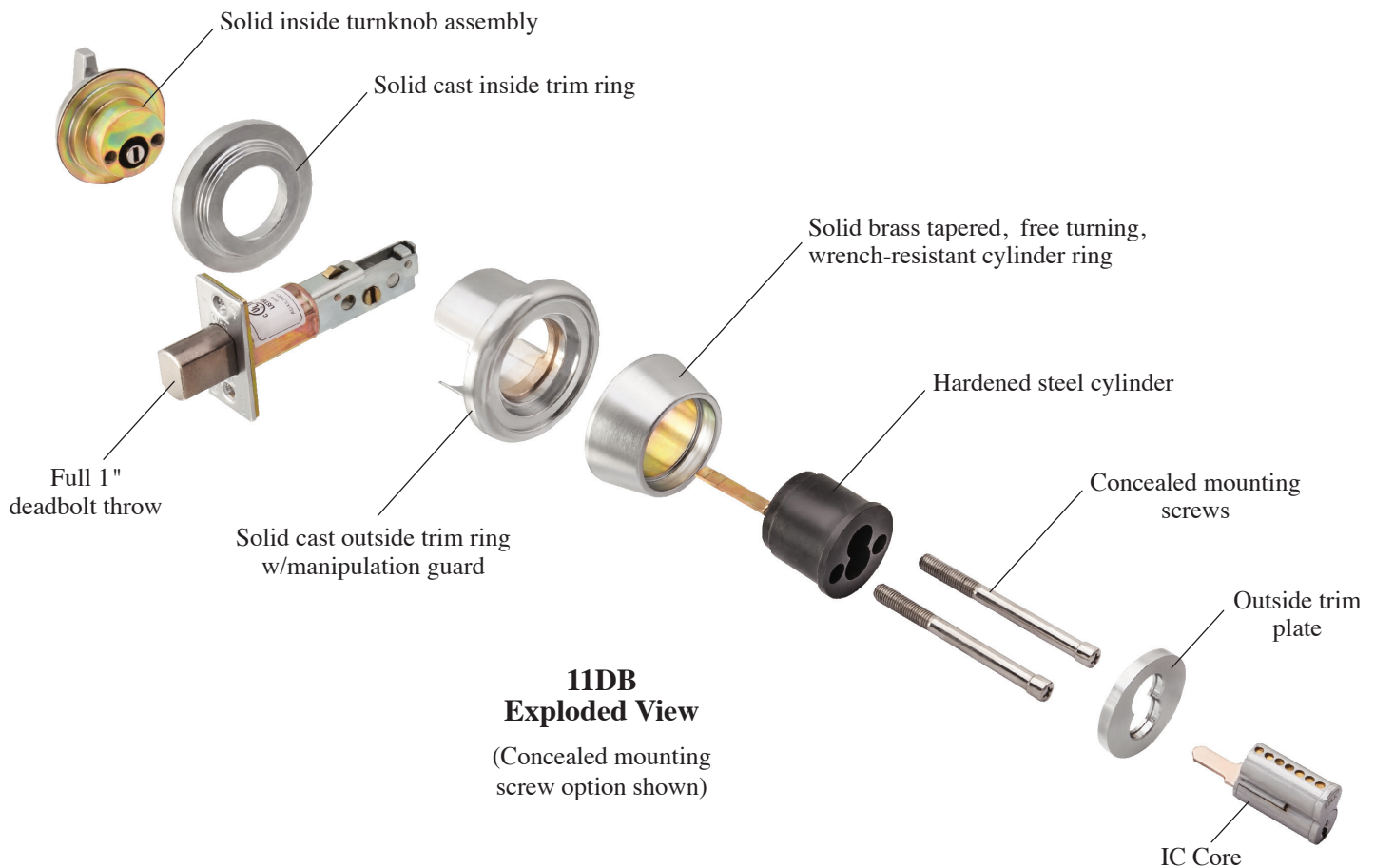

Grade 1 Features

- Solid brass tapered, free turning, wrench resistant cylinder rings for added strength and security.
- Solid cast trim rings both sides for additional strength. Outside ring includes integrated deadbolt manipulation guard to prevent door tampering.
- Full 1" deadbolt throw.
- Double keyed function has concealed mounting screws. Optional concealed mounting screws recommended on single keyed functions for added security.
- Strike plate supplied with standard 3" screws for enhanced security.
- Deadbolt can be supplied with either interchangeable core or standard non-IC cylinder self-aligning installation in industry standard door prep.
- Uniquely tailored masterkey systems backed by extensive industry experienced system design and support.
- 5 Year Warranty.



11DB

Grade 2 Features

- Deadbolt can be supplied with either interchangeable core or standard non-IC cylinder.
- Double keyed function has concealed mounting screws. Concealed mounting screws optional on other functions
- Strike plate supplied with standard 3" screws for enhanced security.
- Self-aligning installation in industry standard door prep.
- Uniquely tailored masterkey systems backed by extensive industry experienced sytem design and support.
- 5 Year Warranty.



2DB

Functions

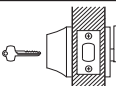
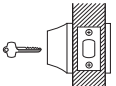
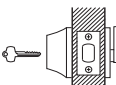
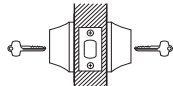
Function	Description	Operation Description
SINGLE KEYED		
	K (E2151/181K) key/thumbturn	<ul style="list-style-type: none"> • Locked or unlocked by turning key 360° in outside cylinder, or turning inside thumbturn.
	L (E2161/181L)	<ul style="list-style-type: none"> • Locked or unlocked by turning key 360° in outside cylinder. • Inside is blank.
	S (E2171/181S) classroom key/thumbturn	<ul style="list-style-type: none"> • Locked or unlocked by turning key 360° in outside cylinder. • Inside thumbturn will unlock door only. • Door cannot be locked by thumbturn.
DOUBLE KEYED**		
	M** (E2141/181M) keyed both sides	<ul style="list-style-type: none"> • Locked or unlocked by turning key in either side 360°.

****ATTENTION:** Locksets that secure both sides of door are a life safety hazard in times of emergency and they should only be used in accordance with existing building and Life Safety Codes®.

Specifications

Door Thickness	1 ³ / ₈ " to 2" wood or metal door.
Backset	2 ³ / ₄ " (standard), or 2 ³ / ₈ " available.
Bolts	1" throw, 2 ³ / ₄ " backset, 1 ¹ / ₈ " x 2 ¹ / ₄ " faceplate. 1" throw, 2 ³ / ₈ " backset, 1" x 2 ¹ / ₄ " faceplate.
Strikes	Square corner (Standard). Steel strike reinforcing plate with 3" screws.
Rings	Solid brass tapered cylinder rings. Cast trim rings with integrated manipulation guard. (11DB)
IC Core	OAK™ Interchangeable 6 & 7 pin compatible with all other small format interchangeable core housings.
Non-IC Plug	Standard "C" keyway, compatible with *Schlage®.
Masterkeying	Tailored masterkey system set-up and design. Construction cores available.
Finishes	605 (bright brass), 606 (satin brass), 612 (satin bronze), 613 (dark bronze), 625 (bright chrome), 626 (satin chrome).
Certification	UL listed "A" label (3 hour) single swing door (4'x8') ANSI A156.36 – 2010.

Deadbolt Door Prep.

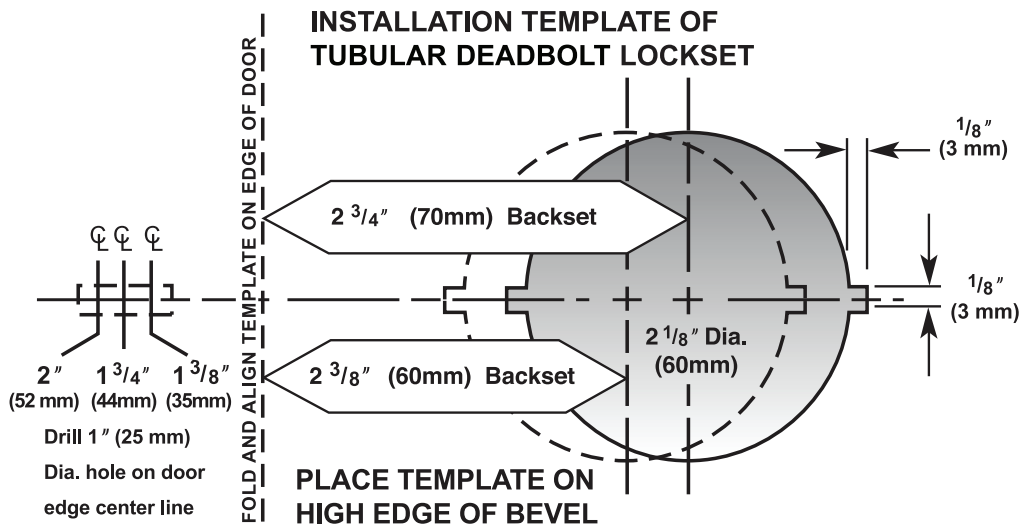

How To Order - Tubular Deadbolts

11DB	3	K	1	SC	626	LC
Series	Backset	Functions	Core	Strike	Finish	Options
11DB Grade 1 Deadbolt	2 – 2 ³ / ₈ " 3 – 2 ³ / ₄ "	K – key/thumbturn L – key/blank M – double keyed** S – key/thumbturn classroom	1 – OAK™ IC 2 – non-I/C plug	SC – square corner (Std.)	605 606 612 613 625 626	LC – less core KE – keyed CS – concealed screws
2DB Grade 2 Deadbolt						

****ATTENTION:** Locksets that secure both sides of door are a life safety hazard in times of emergency and they should only be used in accordance with existing building and Life Safety Codes®.

A Systems Approach To Security

OAK™ Security will develop a comprehensive facility masterkey system bringing a solution to any current keying problems. We will also provide flexibility for any future keying needs.

You may have already made a significant investment into an existing small format interchangeable core system. We can seamlessly integrate our additions into your system and work with you on any necessary expansions to the system.

When a higher level of security is required OAK™ offers a full range of industry leading patented keying options. Our patent protected keying systems ensure that only OAK™ or your designated staff can make and issue patent protected keys. OAK™ is proud to partner with *Medeco® and *Schlage® in providing these patented systems.



Government

NAICS:
332510; 423710; 334290

Cage Code:
43GB3

Duns #:
602666922



Contract Holder
GS-07F-0611X



Finishes

605 – Bright brass(US3)	613 – Dark bronze(US10B)
606 – Satin brass(US4)	625 – Bright chrome(US26)
611 – Bright bronze(US9)	626 – Satin chrome(US26D)
612 – Satin bronze(US10)	630 – Satin stainless steel(US32D)

*Manufacturers' registered trade names used above are for identification and reference only.



Oak Security Group, LLC
Toll-free: 877-OSG-LOCK

C-105-O

www.oaksecurity.com